

# Operation and Installation Manual

## For M741 Series



CE CE RoHS

## CONTENTS

Indoor monitor 2D drawing.....	2
Specification.....	3
Wiring diagram.....	4
Installation instruction.....	5
Installation diagram.....	6
Configuration diagram.....	7
System diagram.....	8
Operation.....	9
Video calling.....	9
Unlocking.....	9
Monitoring.....	10
Indoor monitor call transferring.....	10
Picture Memory Function.....	11
Notice.....	13

### Wiring diagram

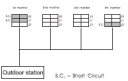
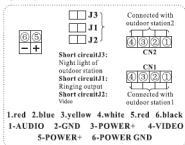

**CAUTION:**

When connect more than one indoor monitor please use a separate power supply for each indoor monitor, and take off jumper J1 of the other monitors.

When connect more than one outdoor station please use a separate power supply for each outdoor station, and take off jumper J1 and J2 of other monitors, see the diagram.

-4-

### Monitoring

In standby mode, press the button (M) , meanwhile Door 1 indicator of indoor monitor flashing and showing the scenery of Door 1 outdoor station's camera. Press the button (M) again, will show scenery of Door 2 outdoor station's camera. Press the button (M) third time, close monitoring. Without the third press, monitoring will be closed in 1 minutes automatically.

In monitoring mode, press the button (M) on indoor monitor can start audio monitoring. Monitoring mode last 1 minutes and each indoor monitor independently of each other.

### Indoor monitor call transferring

In case press the call button on outdoor station, all indoor monitor ring, can be pressed any indoor monitor button (M) for talking, also can be pressed the button forward for the other indoor monitor, the indoor monitor you pressed the button (M) close the talking and standby.

### Notes:

- In this system, in case be connected multi-indoor monitors, just the farthest indoor monitor jumper J2 need put ON, others' keep default setting.
- Put on jumper J1 the outdoor station is ringing tone, or else, has no voice.
- Put on jumper J3 means the outdoor station nightlight on, or else, nightlighting function closed.

-10-

### Installation instruction

#### Notice

- The installation place should be faraway from TV, video record player, PC etc. Electronic units with high intensity EMC.
- Do not drop, knock or shake the unit.
- Shut down the power for the unit while installing.
- The wiring cable installation should keep 30 cm away from the high voltage cable as minimum distance, reducing the disturb from high voltage.
- Before take power for the unit, recheck the wiring diagram and make sure done right connection.
- Meet with unnormal phenomenon when the unit is working, cut down the power first and then do eliminate of defects.
- Eliminate of defects after shut down the power, do check step by step from one unit to another unit, or do cross-test that means take substitute(a new one). After done above processings, if still has unknown defect, contact with our company for after service. Nonexpensive handling may damage the unit.

#### Installation processes

- Position the location when the unit is to be mounted. Use the bracket to mark the accurately location point.
- Use the screw anchors to fill the drilling hole, and screwing fasten the bracket to the wall.
- According to the wiring diagram and do right connection.
- Mounted the unit to the bracket.

-5-

## Picture Memory Function

For the models with picture memory function

### Auto capture

In the calling status or in the monitoring status, the monitor screen will turn on automatically. The outdoor station will capture one picture in the third second and store it automatically after the indoor monitor screen is on. It only captures one picture automatically(Do not support automatic continuity capture).

### Manual capture

In the calling status or in the monitoring status, when the monitor screen displays image well, press (M) to capture a picture. The picture will be saved automatically.

## NOTICE

Maximum storage: 400 pictures. After the number of pictures reaches 400, the oldest picture will be deleted automatically as long as a new picture is captured.

-11-

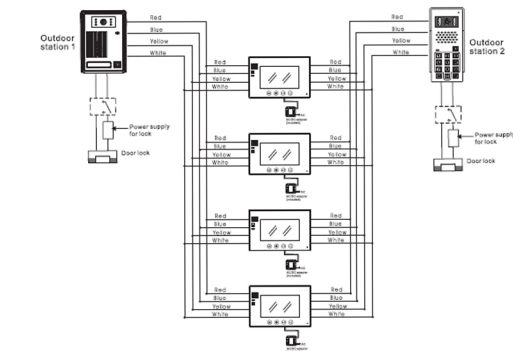

### Installing diagram

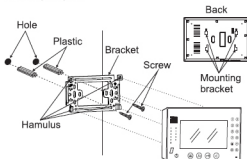

#### INSTRUCTION:

- Cables of requirement: Diameter  $\geq 0.5mm^2$ , from outdoor station to the farthest monitor distance  $\leq 70m$ .
- Each monitor should be parallel connected. One monitor can be extended 3 monitors as maximum extension. One monitor can be connected 2 outdoor stations as maximum.

-6-

## CONFIGURATION DIAGRAM

### WITH TWO ENTRANCE

Indoor monitor external power supply

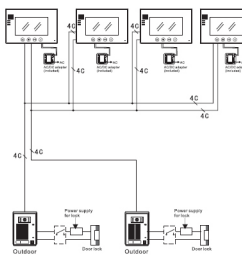

-7-

## Indoor monitor 2D drawing

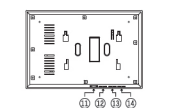
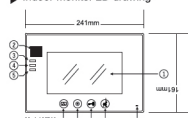

-2-

## SYSTEM DIAGRAM

### Wiring connections

1. Red 1-Audio 2. Blue 2-GND 3. Yellow 3-Power+ 4. White 4-Video

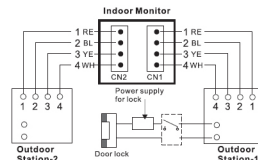

-8-

NO.	Function	NO.	Function
①	TFT	⑪	Microphone
②	Speaker	⑫	Brightness
③	Power and talking indicator	⑬	Chroma
④	Door 1 calling indicator	⑭	Volume
⑤	Door 2 calling indicator	⑮	Ring adjust
⑥	Monitor(Touch button)	⑯	Manual capture picture
⑦	Calling(Touch button)	⑰	Picture review
⑧	Unlock(Touch button)	⑱	Page up
⑨	Talking(Touch button)	⑲	Page down

### Specification

Working condition	Temperature: -10 ~ +55°C
	RH < 95%
Voltage	DC14.5V
Standby current	< 50mA
Working current	< 600mA
Mode	Dual transmission
Talking time	2 minutes

## OPERATION

### Visitor calling

Visitor press the call button of outdoor station, all indoor monitor showing the indicator of the outdoor station position and ringing, and visitor image on the indoor monitor display panel. Press the button (M) of any indoor monitor, start talking, same time, other indoor monitor can press the button (M) achieve to third-party call, repress the button (M) of any indoor monitor close the talking and all display of all indoor monitor closed. Max talking time lasts 2 minutes, no answer, calling last 1 minutes. One-time talking mode, means one indoor monitor talk to one outdoor station, other indoor monitors will just show the visitor, at same time, press the call button from other outdoor station, one-time talking will cut, and the latest called outdoor station start talking to the indoor monitor. Corresponding indicator flashing in case outdoor station calling.

### Unlocking

Calling from outdoor station to indoor monitor, the indoor monitor will be ringing and talking indicator LED on, the visitor's image will be displayed on the screen. Press the button (M) for unlocking the door. In monitoring mode, press the button (M) for unlocking the door.

-9-

## Notice

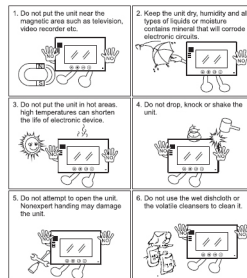

-12-

-13-